

ROULEAU À VERT JACOBSEN
GREEN ROLLER JACOBSEN

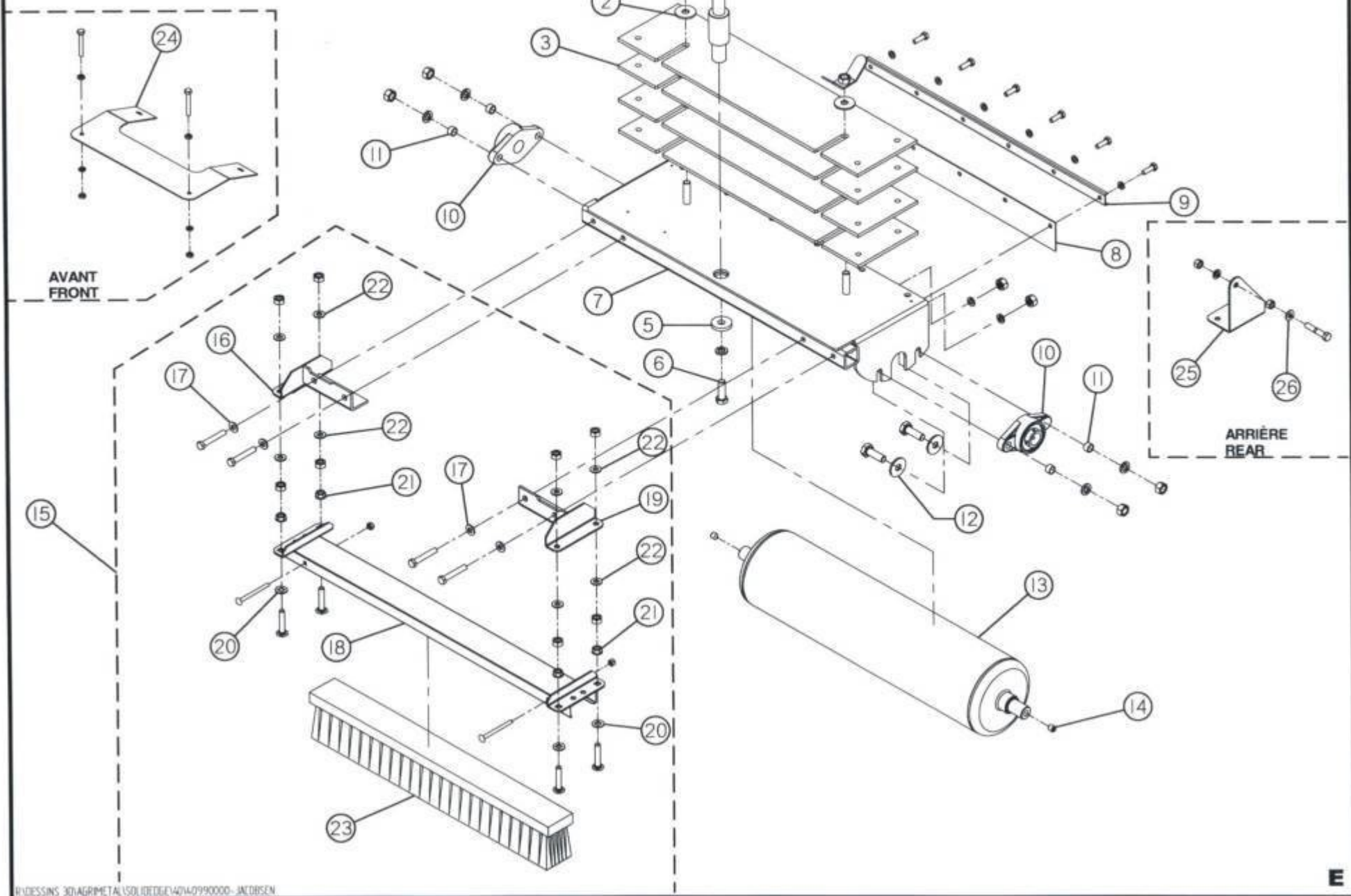

GREEN ROLLER JACOBSON GX IV-V

REF.	PART NO.	DESCRIPTION	QTE
1	40-50-0000	WING NUT	6
2	01-01-1660	FLAT WASHER 1 1/2 Dia. X Ø 33/64 X 11GA	6
3	40-04-0200	WEIGHT	12
4	40-20-0050	VERTICAL AXLE (JACOBSEN 1860)	3
5	40-04-0205	FLAT WASHER 1 1/2" DIA. X Ø 33/64" X 1/4"	3
6	NC01-29-0249	HEX.BOLT 1/2"-20 X 1 1/2 (GRADE 5)	3
7	40-55-2020	BODY LEFT " STICKER INCLUDED" (JACOBSON)	1
N/I	40-55-2025	BODY RIGHT " STICKER INCLUDED" (JACOBSON)	1
N/I	40-55-2030	BODY REAR " STICKER INCLUDED" (JACOBSON)	1
8	40-42-0400	PLASTIC SCRAPER	3
9	40-01-3005	SCRAPER HOLDER	3
10	01-38-0000	FLANGE BEARING UCFL 205-16 X Ø 1"	6
11	NC13-80-0061	BUSHING 5/8" X 1/2" X 3/8"	12
12	01-01-1660	FLAT WASHER 1 1/2 Dia. X Ø 33/64 X 11GA	12
13	40-50-0020	ROLLER	3
14	NC02-44-0203	ALLEN 6 PANS 1/4-18 NPT	6
15	40-55-0015	OPT.BRUSH KIT ASSY.	3
16	40-50-0030	LEFT L SUPPORT	3
17	01-01-2485	FLAT WASHER 13/16" Dia. X Ø 25/64" X 14GA	12
18	40-50-0025	BRUSH SUPPORT	3
19	40-50-0035	RIGHT L SUPPORT	3
20	40-22-2200	SHIM 7/8" X Dia. X Ø 25/64" X 14 GA	12
21	NC02-14-0019	FLANGE HEX. LOCKNUTS 3/8"-16 (GRADE B)	12
22	01-01-2485	FLAT WASHER 13/16" Dia. X Ø 25/64" X 14GA	24
23	NC13-80-0175	YELLOW NYLON BRUSH 2 1/2" LARGE 24" LG	3
24	40-01-2400	FRONT HYDRAULIC MOTOR SUPPORT	1
25	40-01-1515	REAR HYDRAULIC MOTOR SUPPORT	1
26	01-01-2485	FLAT WASHER 13/16" Dia. X Ø 25/64" X 14GA	1

N/I	40-58-0000	STICKER "KIT" (GREEN ROLLER JD T2500)	1
N/I	01-60-0005	STICKER AGRIMÉTAL INC "SMALL"	6
N/I	40-60-0000	STICKER GAUCHE / LEFT...	1
N/I	40-60-0005	STICKER DROITE / RIGHT...	1
N/I	40-60-0010	STICKER ARRIERE / REAR...	1
N/I	NC13-33-0125	STICKER CAUTION (OPERATION MANUAL)	3