

ROULEAU À VERT RT2500
GREEN ROLLER RT2500

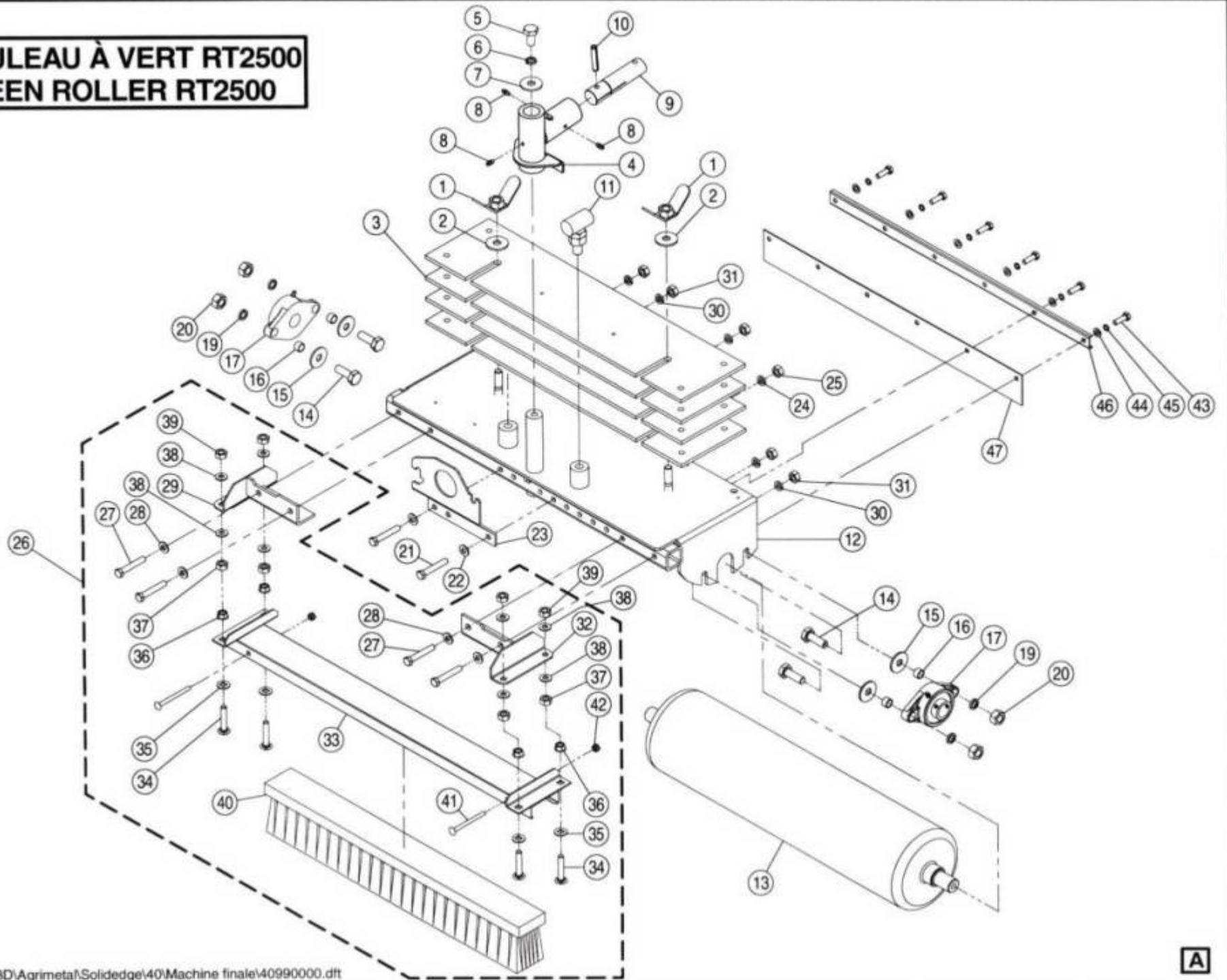

GREEN ROLLER JD T2500

REF.	PART NO.	DESCRIPTION	QTE
1	40-50-0000	WING NUT	6
2	01-01-1660	FLAT WASHER 1 1/2 Dia. X Ø 33/64 X 11GA	6
3	40-04-0200	WEIGHT	12
4	40-50-0010	PIVOT	3
5	NC01-17-0247	HEX.BOLT 1/2"-13 X 1" LG (GRADE 2)	3
6	NC02-32-0014	LOCK WASHER Ø 1/2"	3
7	01-01-1660	FLAT WASHER 1 1/2 Dia. X Ø 33/64 X 11GA	3
8	NC01-69-0785	GREASE FITTING 1/4"-28 (STRAIGHT)	9
9	40-20-0100	HORIZONTAL AXLE (JD 2500)	3
10	NC01-69-0507	SPRING PIN 3/8" X 2" LG	3
11	40-55-0010	STOPPER	3
12	40-50-0015	BODY (RT-2500)	3
13	40-50-0020	ROLLER	3
N/I	NC02-44-0203	ALLEN 6 PANS 1/4-18 NPT	6
14	NC01-17-0249	HEX.BOLT 1/2"-13 X 1 1/2" (GRADE 2)	12
15	01-01-1660	FLAT WASHER 1 1/2 Dia. X Ø 33/64 X 11GA	12
16	NC13-80-0061	BUSHING 5/8" X 1/2" X 3/8"	12
17	01-38-0000	FLANGE BEARING UCFL 205-16 X Ø 1"	6
19	NC02-32-0014	LOCK WASHER Ø 1/2"	12
20	NC02-07-0020	HEX.NUT 1/2"-13	12
21	NC01-17-0119	HEX.BOLT 3/8"-16 X 2 1/4" LG (GRADE 2)	6
22	01-01-2485	FLAT WASHER 13/16" Dia. X Ø 25/64" X 14GA	6
23	40-01-0900	HYDRAULIC MOTOR SUPPORT	3
24	NC02-32-0012	LOCK WASHER Ø 3/8"	6
25	NC02-07-0018	HEX.NUT 3/8"-16	6
26	40-55-0015	OPT.BRUSH KIT ASSY.	3
27	NC01-17-0119	HEX.BOLT 3/8"-16 X 2 1/4" LG (GRADE 2)	12
28	01-01-2485	FLAT WASHER 13/16" Dia. X Ø 25/64" X 14GA	12
29	40-50-0030	LEFT L SUPPORT	3
30	NC02-32-0012	LOCK WASHER Ø 3/8"	12
31	NC02-07-0018	HEX.NUT 3/8"-16	12
32	40-50-0035	RIGHT L SUPPORT	3
33	40-50-0025	BRUSH SUPPORT	3
34	NC01-02-0113	CARRIAGE BOLT 3/8"-16 X 2" LG (GRADE 2)	12
35	40-22-2200	SHIM 7/8" X Dia. X Ø 25/64" X 14 GA	12
36	NC02-14-0019	FLANGE HEX. LOCKNUTS 3/8"-16 (GRADE B)	12
37	NC02-07-0018	HEX.NUT 3/8"-16	12
38	01-01-2485	FLAT WASHER 13/16" Dia. X Ø 25/64" X 14GA	16
39	NC02-07-0018	HEX.NUT 3/8"-16	12
40	NC13-80-0175	YELLOW NYLON BRUSH 2 1/2" LARGE 24" LG	3
41	NC01-02-0013	CARRIAGE BOLT 1/4"-20 X 3" LG (GRADE 2)	6
42	NC01-96-0009	NYLON INSERT LOCKNUTS 1/4"-20	6
43	NC01-17-0060	HEX.BOLT 5/16"-18 X 1" LG (GRADE 2)	18
44	NC02-22-0008	FLAT WASHER Ø 5/16"	18
45	NC02-32-0011	LOCK WASHER Ø 5/16"	18
46	40-01-3005	SCRAPER HOLDER	3
47	40-42-0400	PLASTIC SCRAPER	3

N/I	40-58-0000	STICKER "KIT" (GREEN ROLLER JD T2500)	1
N/I	01-60-0005	STICKER AGRIMÉ TAL INC "SMALL"	6
N/I	40-60-0000	STICKER GAUCHE / LEFT...	1
N/I	40-60-0005	STICKER DROITE / RIGHT...	1
N/I	40-60-0010	STICKER ARRIERE / REAR...	1
N/I	NC13-33-0125	STICKER CAUTION (OPERATION MANUAL)	3