

# ROULEAU À VERT T2500 GREEN ROLLER T2500

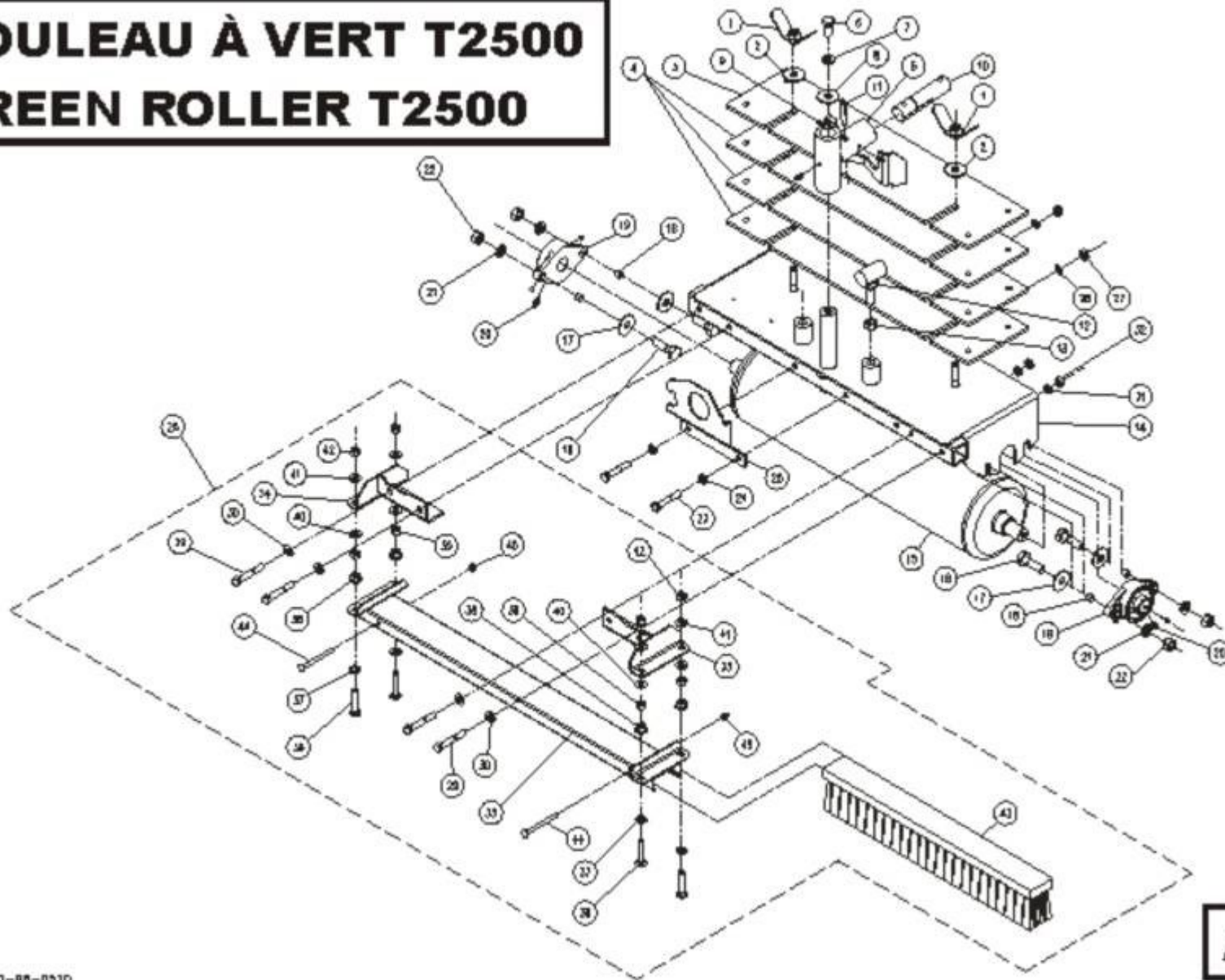

40-88-0310

**A**

## GREEN ROLLERS RT2500

REF.	PART NO.	DESCRIPTION	QTE
1	40-50-0000	WING NUT	6
2	01-01-1660	FLAT WASHER 1 1/2 Dia. X Ø 33/64 X 11GA	6
4	40-04-0200	WEIGHT	12
5	40-50-0010	PIVOT	3
6	NC01-17-0247	HEX.BOLT 1/2"-13 X 1" LG (GRADE 2)	3
7	NC02-32-0014	LOCK WASHER Ø 1/2"	3
8	01-01-1660	FLAT WASHER 1 1/2 Dia. X Ø 33/64 X 11GA	3
9	NC01-69-0785	GREASE FITTING 1/4"-28 (STRAIGHT)	9
10	40-20-0100	HORIZONTAL AXLE (JD 2500)	3
11	NC01-69-0507	SPRING PIN 3/8" X 2" LG	3
12	40-50-0005	ADJUSTABLE STOPPER	3
13	NC02-07-0022	HEX. NUT 5/8"-11	3
14	40-50-0015	BODY (RT-2500)	3
15	40-50-0020	ROLLER	3
N/I	NC02-44-0203	ALLEN 6 PANS 1/4-18 NPT	2
16	NC01-17-0249	HEX.BOLT 1/2"-13 X 1 1/2" (GRADE 2)	12
17	01-01-1660	FLAT WASHER 1 1/2 Dia. X Ø 33/64 X 11GA	12
18	NC13-80-0061	BUSHING 5/8" X 1/2" X 3/8"	12
19	01-38-0000	FLANGE BEARING UCFL 205-16 X Ø 1"	6
20	NC01-69-0785	GREASE FITTING 1/4"-28 (STRAIGHT)	3
21	NC02-32-0014	LOCK WASHER Ø 1/2"	12
22	NC02-07-0020	HEX.NUT 1/2"-13	12
23	NC01-17-0119	HEX.BOLT 3/8"-16 X 2 1/4" LG (GRADE 2)	6
24	01-01-2485	FLAT WASHER 13/16" Dia. X Ø 25/64" X 14GA	12
25	40-01-0900	HYDRAULIC MOTOR SUPPORT	3
26	NC02-32-0012	LOCK WASHER Ø 3/8"	6
27	NC02-07-0018	HEX.NUT 3/8"-16	6
28	40-55-0015	OPT.BRUSH KIT ASSY.	3
29	NC01-17-0119	HEX.BOLT 3/8"-16 X 2 1/4" LG (GRADE 2)	12
30	01-01-2485	FLAT WASHER 13/16" Dia. X Ø 25/64" X 14GA	12
31	NC02-32-0012	LOCK WASHER Ø 3/8"	12
32	NC02-07-0018	HEX.NUT 3/8"-16	3
33	40-50-0025	BRUSH SUPPORT	3
34	40-50-0030	LEFT L SUPPORT	3
35	40-50-0035	RIGHT L SUPPORT	3
36	NC01-02-0113	CARRIAGE BOLT 3/8"-16 X 2" LG (GRADE 2)	12
37	40-22-2200	SHIM 7/8" X Dia. X Ø 25/64" X 14 GA	12
38	NC02-14-0019	FLANGE HEX. LOCKNUTS 3/8"-16 (GRADE B)	12
39	NC02-07-0018	HEX.NUT 3/8"-16	12
40	01-01-2485	FLAT WASHER 13/16" Dia. X Ø 25/64" X 14GA	12
41	01-01-2485	FLAT WASHER 13/16" Dia. X Ø 25/64" X 14GA	12
42	NC02-07-0018	HEX.NUT 3/8"-16	12
43	NC13-80-0175	YELLOW NYLON BRUSH 2 1/2` LARGE 24` LG	3
44	NC01-02-0013	CARRIAGE BOLT 1/4`-20 X 3" LG (GRADE 2)	6
45	NC01-96-0009	NYLON INSERT LOCKNUTS 1/4"-20	6
	-----		
N/I	40-58-0000	STICKER "KIT" (GREEN ROLLER JD T2500)	1
N/I	01-60-0005	STICKER AGRIMÉTAL INC "SMALL"	6
N/I	40-60-0000	STICKER GAUCHE / LEFT...	1
N/I	40-60-0005	STICKER DROITE / RIGHT...	1
N/I	40-60-0010	STICKER ARRIERE / REAR...	1